

LEAD-LINED SINK AND WASTE CABINET

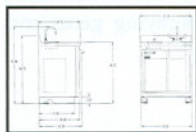

Two sections for hot and cold waste

The Sink and Waste Cabinet performs three functions. A stainless steel sink allows the convenience of running water in the hot lab. The space under the sink is used for cold storage. Separated from the sink section by a lead barrier, the waste section includes a shielded port that allows waste to be dropped into a polyethylene container for storage until decayed.



Cabinet drawing dimensions can be accessed at www.biodex.com

SPECIFICATIONS:

Dimensions: 30.5" w x 24" depth x 36.5" h (77.5 x 61 x 92.7 cm)

Lead Shielding: .25" (.64 cm), .5" (1.3 cm) or 1" (2.5 cm) thick on all six sides

Sink Section: 10" w x 14" depth x 10" h (25.4 x 35.6 x 25.4 cm)

Integral stainless steel sink with gooseneck faucet and wrist blades; suitable for cold storage

Waste Section:

Chute: 6.5" dia (16.5 cm) with .5" thick (1.3 cm) lead shielded cover

Container: I.D.: 20.5" h x 11.25" dia (52 x 28.6 cm), polyethylene, 7 gal capacity

Door: Key-locked

Countertop: Stainless steel with 4" backsplash and .5" spillproof lip

Finish: Powder coat

Weight:

244-130: 849 lb (386 kg)

244-131: 1253 lb (569.5 kg)

244-132: 2260 lb (1027.3 kg)

244-130 Cabinet, Sink and Waste, .25" lead

244-131 Cabinet, Sink and Waste, .5" lead

244-132 Cabinet, Sink and Waste, 1" lead

Note: Reverse door swing available.

Call for quote.